

35 A GLASS PASSIVATED BRIDGE RECTIFIER

Reverse Voltage - 100 to 1000 V

Forward Current – 35 A

Features

- ◆ Glass passivated die construction
- ◆ Low forward voltage drop
- ◆ Plastic material-UL flammability 94V-0
- ◆ Lead free in comply with EU RoHS 2011/65/EU directives

Mechanical Data

- ◆ Case: GBPCW
- ◆ Polarity: Symbol marked on body
- ◆ Mounting Position: Any
- ◆ Lead Free: For RoHS / Lead Free Version

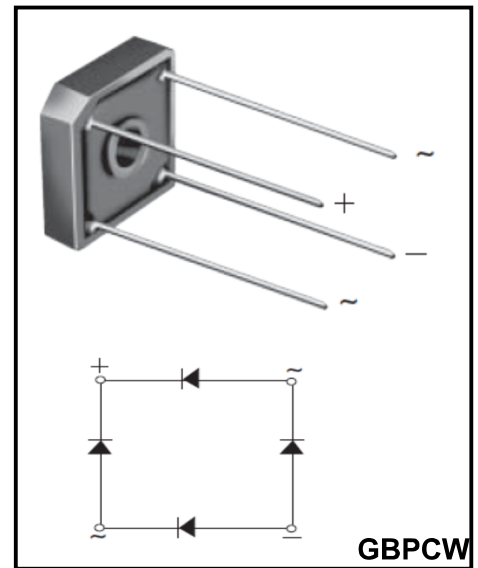

Maximum Ratings and Electrical characteristics

Ratings at 25 °C ambient temperature unless otherwise specified.

Parameter	Symbols	GBPC 3501W	GBPC 3502W	GBPC 3504W	GBPC 3506W	GBPC 3508W	GBPC 3510W	Units
Maximum Repetitive Peak Reverse Voltage	V_{RRM}	100	200	400	600	800	1000	V
Maximum RMS Voltage	V_{RWM}	70	140	280	420	560	700	V
Maximum DC Blocking Voltage	V_{RMS}	100	200	400	600	800	1000	V
Maximum Average Forward Rectified Current @TC=55 °C	$I_{(AV)}$	35						A
Peak Forward Surge Current, 8.3mS Single Half Sine-Wave, Superimposed on Rated Load (JEDEC Method)	I_{FSM}	400						A
I^2t Rating for Fusing (t<8.3mS)	I^2t	664						A ² S
Peak Forward Voltage per Diode at 17.5A DC	V_F	1.1						V
Maximum DC Reverse Current at Rated @TJ=25°C DC Blocking Voltage per Diode @TJ=125°C	I_R	5 500						uA
Operating and Storage Temperature Range	Tj, Tstg	-55 ~ +150						°C

Rating and Characteristic Curves

Fig. 1 - Forward Current Derating Curve

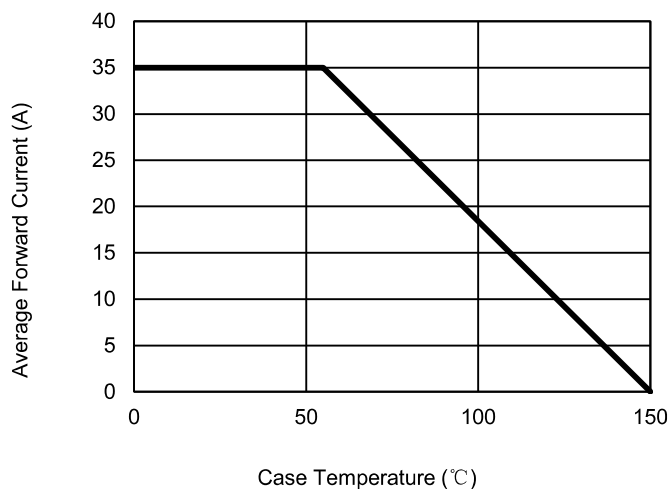

Fig. 2 - Maximum Non-Repetitive Surge Current

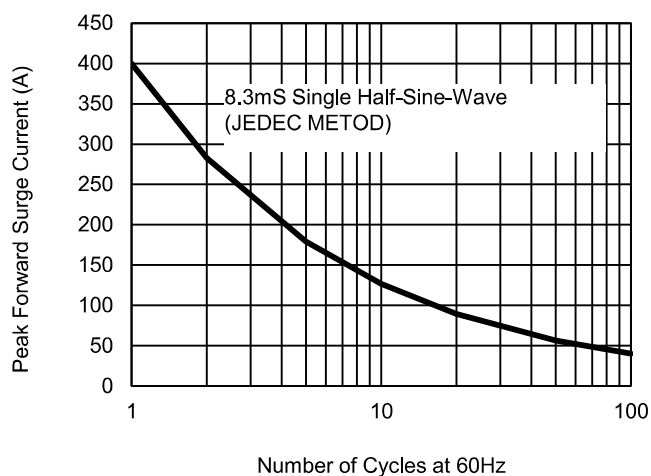

Fig. 3 - Typical Reverse Characteristics

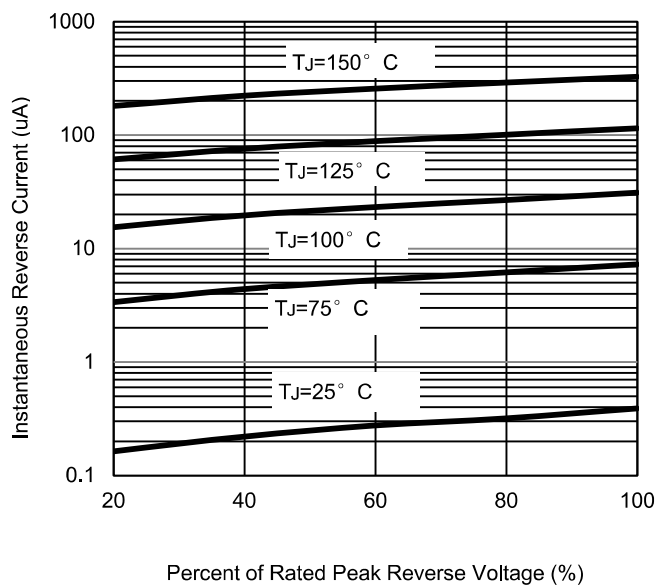
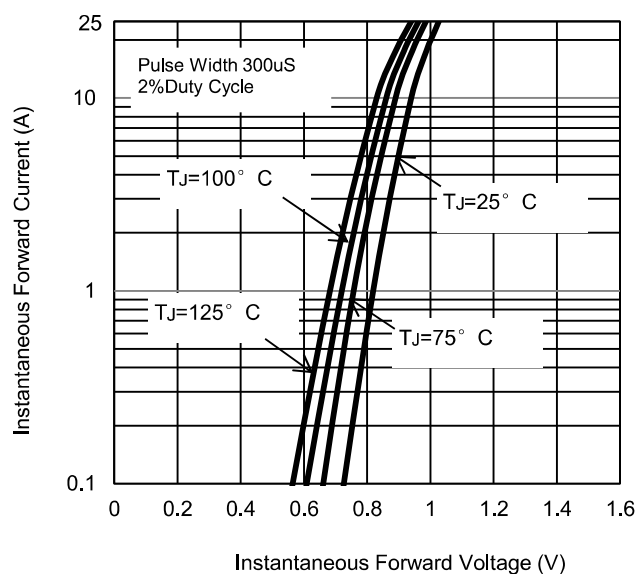
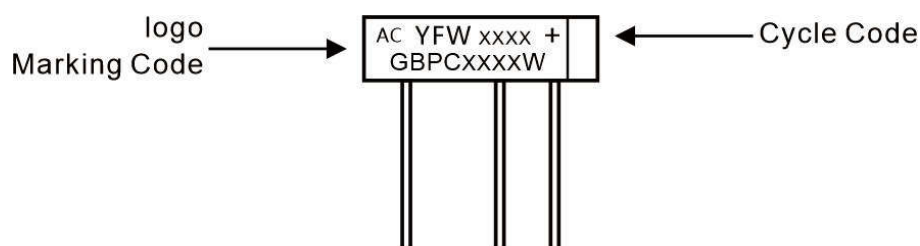

Fig. 4 - Typical Forward Characteristics



Marking Diagram



Ordering information

Package	Packing Description	Packing Quantity
GBPCW	bulk	50PCS/Box 500PCS/Carton

Package Dimensions

GBPCW

Dim.	Millimeter(mm)		DimensionsinInch	
	Min.	Max.	Min.	Max.
A	28.2	28.8	1.11	1.13
B	17.1	19.1	0.67	0.75
C	10.4	12.4	0.41	0.49
D	0.95	1.05	0.04	0.04
E	7.6	8.2	0.30	0.32
F	30	/	1.18	/

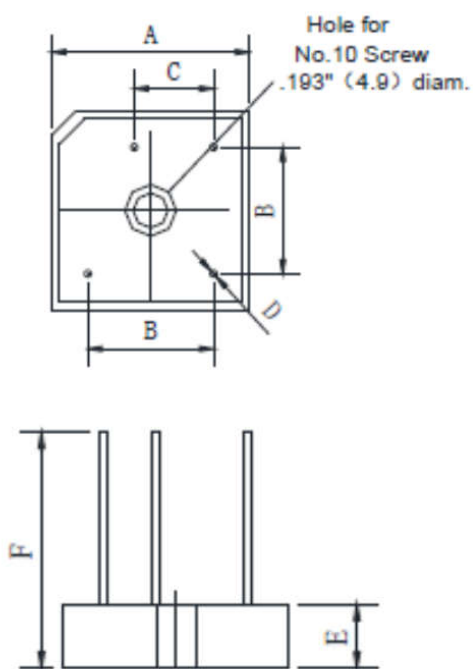

Disclaimer

The information presented in this document is for reference only. GuangDong Youfeng Microelectronics Co.,Ltd. reserves the right to make changes without notice for the specification of the products displayed herein to improve reliability, function or design or otherwise. The product listed herein is designed to be used with ordinary electronic equipment or devices, and not designed to be used with equipment or devices which require high level of reliability and the malfunction of which would directly endanger human life (such as medical instruments, transportation equipment, aerospace machinery, nuclear-reactor controllers, fuel controllers and other safety devices), YFW or anyone on its behalf, assumes no responsibility or liability for any damages resulting from such improper use of sale. This publication supersedes & replaces all information previously supplied. For additional information, please visit our website <https://www.yfwdiode.com>, or consult YFW sales office for further assistance.